



## FEATURES

- Double acting cylinder for holding, opening and closing the jaws for safe and secure grip on job.
- The easy jaw operating system prevent puller jaws from sliding and/or springing off the work object always.
- Self-centering design keeps the arms slide inwards or outwards simultaneously.
- Electric Pump advances and retracts the pushing cylinder only to prevent operating errors from happening.
- 50 Ton Cylinder is single-acting, spring return type with a maximum working pressure of 10,000 psi.
- Electric Hydraulic pump is two stage version ; the low pressure stage provides the fast stroking to save time ; the high pressure stage is controlled by remote hand switch.
- Puller can be adjusted 5 degree vertically.
- The cart has two swivel castors which can provide the movement of cart easily.

- Four extensions are included for the needs on extra stroke.
- PRE50T is designed as the competitive version for costwise option.

**\* This model is patented in Taiwan & Germany, and patent pending in USA & PRC.**

PRE50T  
( Short Jaw Model )



# 50 TON EASY PULLER

MODEL:PME50T

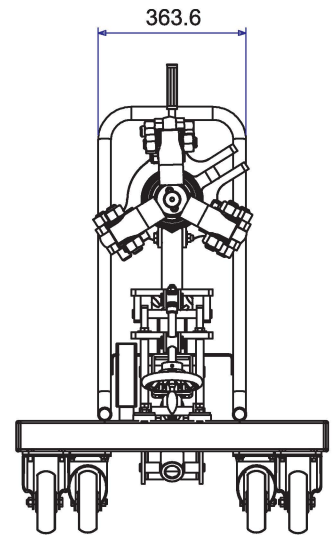
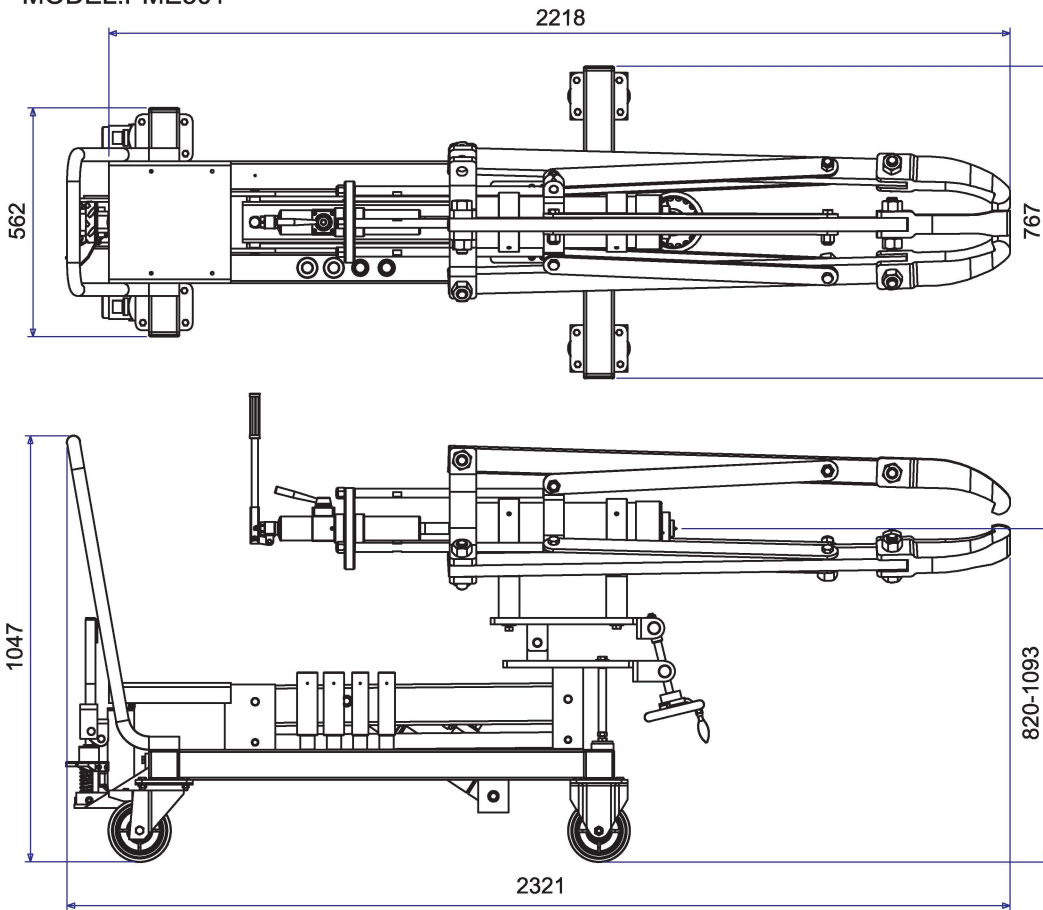

Extension Rods

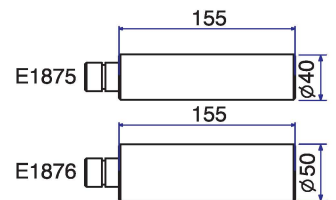

MODEL:PRE50T

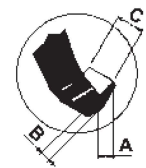
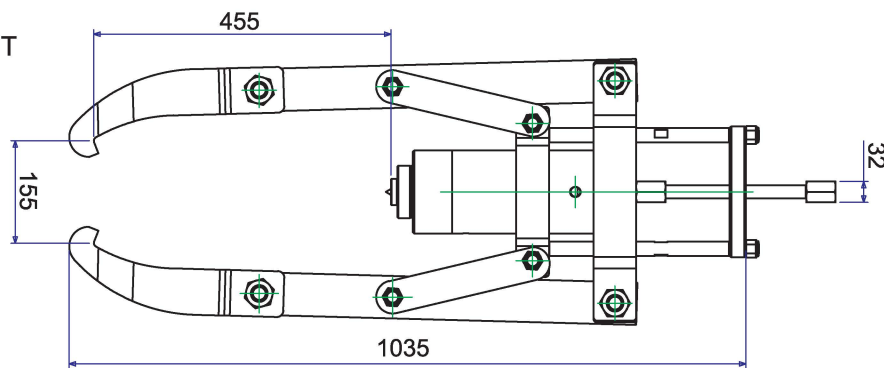

Jaw Tip

## SPECIFICATIONS

Model No.	Reach (Max/mm)	Spread (Min-Max)	Stroke (mm)	Overall Dimensions (mm)	Power Source	Weight (kgs)	Jaw Tip			Extension Rod***	
							A	B	C	E1876	E1875
PME50TE*	780	200-1250	330	2545x800x1155	220V / 50Hz	400				2	2
PME50T	780	200-1250	330	2545x800x1155	---	369	23	35	60	2	2
PRE50T**	455	160-860	159	364x1035	---	140				1	1

\* This model is equipped with Electric Pump - EP18S.

\*\* The hand pump is not included in this model, recommend model is AHP703.

\*\*\* Quantity of extension rod are included.

## ELECTRIC PUMP - Specification

Model No.	Acting	Reservoir Capacity (c.c.)	Function	Motor	Oil Del. ( c.c./min. @ )			
					0 psi	100 psi	5000 psi	10000 psi
EP18S	Single	8000	Hold/Retract	0.45KW 220V 50/60 Hz Single Phase	4000	2800	330	280

# 100 & 150 TON EASY PULLER

**POWERRAM**  
HYDRAULIC TOOLS

**Simple & Easy, User-Friendly,  
Safety and Cost Saving - Our Goals Always!**

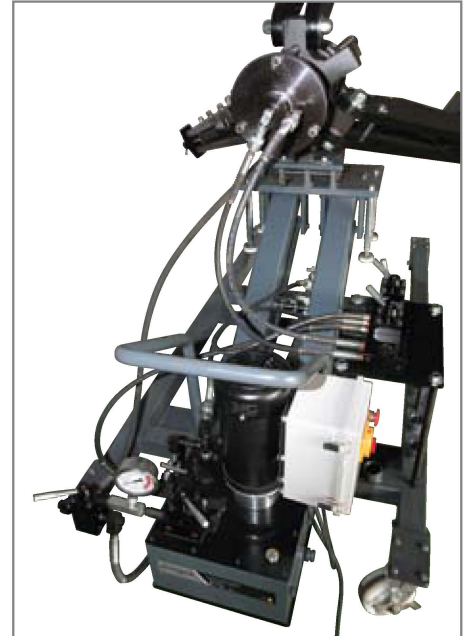

## FEATURES

- Double acting hydraulic system for holding, opening & closing jaws for safe & secure grip on work object always.
- Self-centering design keeps puller jaws clamp work object evenly and automatically.
- Electrical Hydraulic Pump advances and retracts the pushing cylinder only to prevent operating errors from happening.
- The easy jaw head adjusting system prevents puller jaws from sliding and spring off the work object being pulled always.
- Puller can be converted into 2 or 3-WAY configurations.
- Puller can be adjusted with 5 degree up/down of puller centerline for precisely positioning.
- The cart swivel castors provide movement of cart easily.
- Electrical Hydraulic Pump is two stage version ; the low pressure stage provides the fast stroking to save time ; the high pressure stage is controlled by remote switch.
- 100 Ton Cylinder is 2-stages, spring return type with a maximum working pressure of 10,000 psi.
- Five extension adapters are standard attachments for the needs on extra stroke.
- **Integrated Control System for operating Lift and Push easily and efficiently by Electric Pump only. ( Equipment on requesting )**

**\* These models are patented in Taiwan, Germany, USA & PRC.**

# 100 TON EASY PULLER

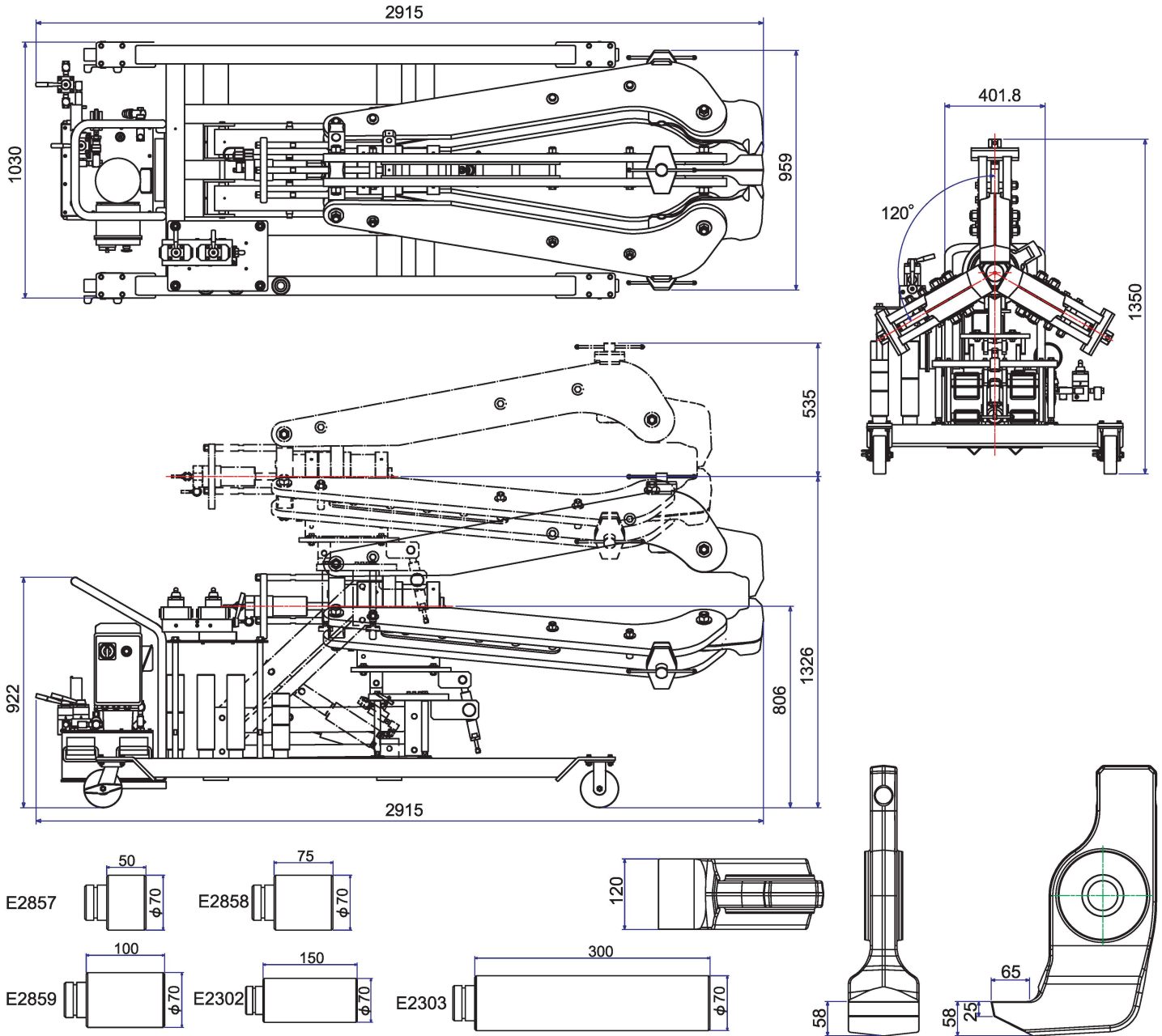

## EXTENSIONS & JAW TIP

Part No.	Dia. (mm)	Length (mm)	Qty (pc)	Jaw Tip Dimensions (mm)
E2857	70	50	1	Tip Depth: 65 Tip Clearance: 25 - 58 Tip Width: 120
E2858		75	1	
E2859		100	1	
E2302		150	2	
E2303		300	2	

## SPECIFICATIONS

Model No.	Reach (Min-Max)	Spread (Min-Max)	Stroke (mm)	Overall Dimensions (mm)	Power Sources	Weight (kgs)
PME100T	952-1220	300-1500	270	2915x1035x1350	---	1083
PME100TE*	952-1220	300-1500	270	2915x1035x1350	---	1189

\* This model is equipped with the Electric Pumps according to Customer's requirement.

### \* ELECTRIC PUMPS:

We suggest two models of EP211 & EP420 as the options.  
Please contact with our distributors for further information.

# 150 TON EASY PULLER

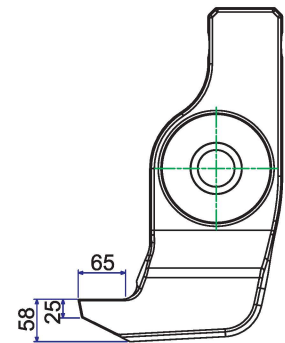
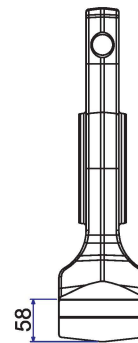
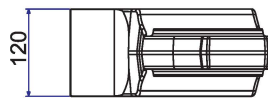
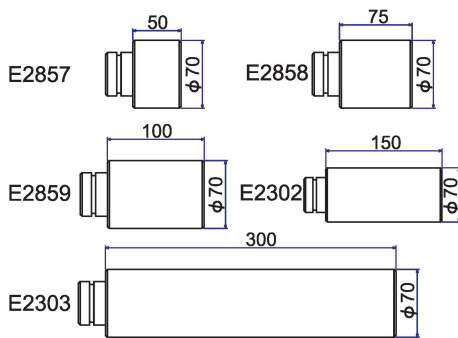
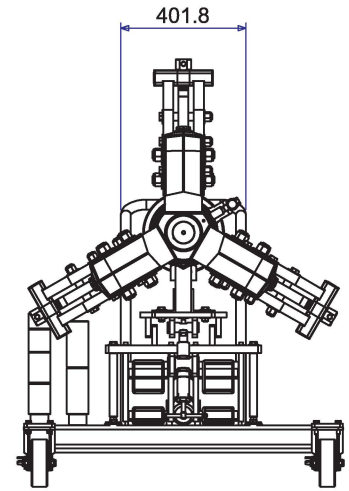
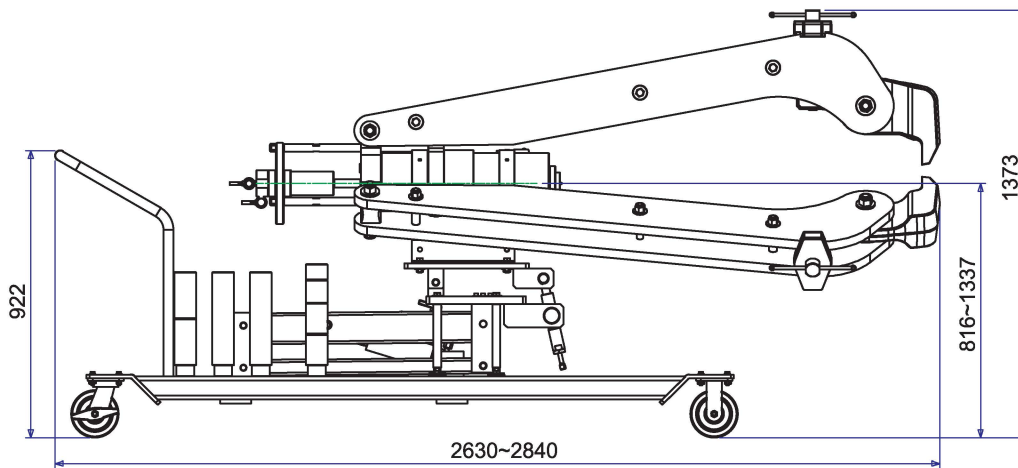
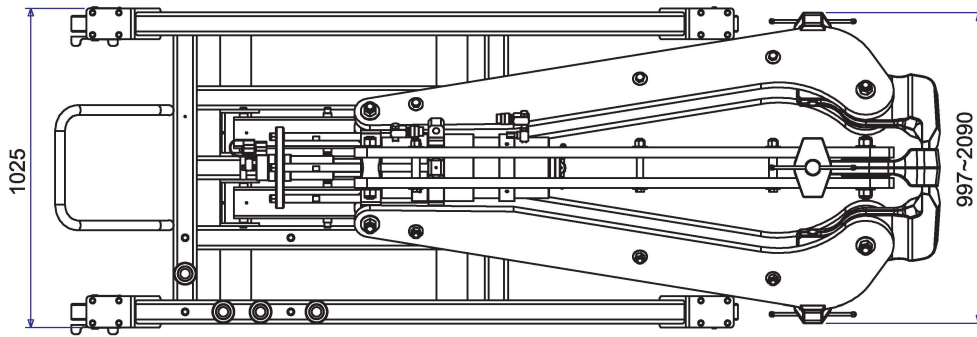

## EXTENSIONS & JAW TIP

Part No.	Dia. (mm)	Length (mm)	Qty (pc)	Jaw Tip Dimensions (mm)
E2857	70	50	1	Tip Depth: 65 Tip Clearance: 25 - 58 Tip Width: 120
E2858		75	1	
E2859		100	2	
E2302		150	2	
E2303		300	2	

## SPECIFICATIONS

Model No.	Reach (Min-Max)	Spread (Min-Max)	Stroke (mm)	Overall Dimensions (mm)	Power Sources	Weight (kgs)
PME150T	970-1175	300-1650	330	2990x1030x1390	---	1158
PME150TE*	970-1175	300-1650	330	2990x1030x1390	EP420	1223

\* This model is equipped with the Electric Pump - EP420 & Control Panel System.